

Highly Motivated Sellers

REAL ESTATE



3 Approved Building Lots in Hawthorne Hill Development
Town of New Lebanon, County of Columbia, State of New York
Offered Below Market Values --- Lots are Adjacent To Each Other.

******Make an Offer******

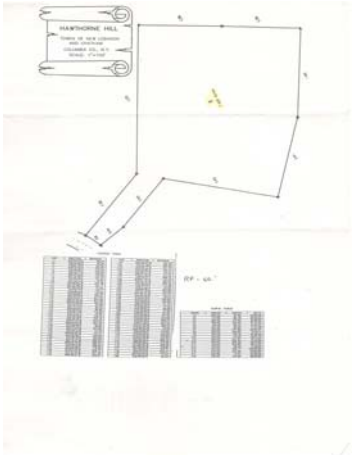

6 Hawthorne Hill Road
SBL: 7.-1-55.1
Lot Size: 7.595+/- Acres
Rural Vac-10
Site: Res 1
Neighborhood: 04802
School District: New Lebanon
Total Assessment: 47,400.00
Deed Book/Page: C384/F1579
Total Annual Taxes: \$957.06+/-
Asking: \$36,900.00

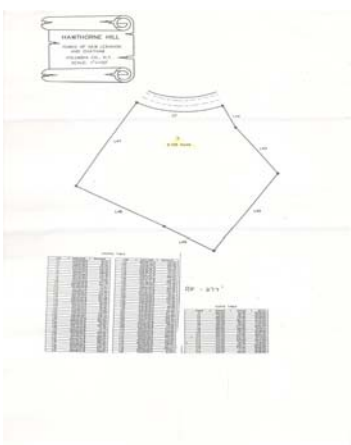

7 Hawthorne Hill Road
SBL: 7.-1-54.1
Lot Size: 5.30+/- Acres
Property Class: 314 -
Site: Res 1
Neighborhood: 04802
School District: New Lebanon
Total Assessment: 47,400.00
Deed Book/Page: C384/F1579
Total Annual Taxes: \$957.06+/-
Asking: \$34,900.00

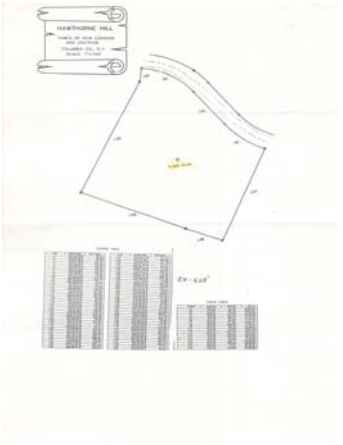

8 Hawthorne Hill Road
SBL: 7.-1-56.1
Lot Size: 5.20 +/- Acres
Property Class: 314 -
Site: Res 1
Neighborhood: 04802
School District: New Lebanon
Total Assessment: \$47,400.00
Deed Book/Page: C384/F1579
Total Annual Taxes: \$957.06 +/-
Asking: \$34,900.00

Collar City Auction Realty & Mgmt., Inc.
9423 Western Tpke, Delanson, NY 12053
518-895-8150 ♦ 518-895-8152 Fax
email: service@collarcityauctions.com



WE CAN SELL YOUR PROPERTY TOO!